



Project By
PADMAVATI
Builders And Developers



Marketed by :
KANAKRATNA
VENTURES

**विमल
शांती**
शेल्टर्स

2 BHK ROW HOUSE
READY TO MOVE



MAHARERA
No.P51500023715



२३ ये हाऊरोसा भव्य प्रकल्प

📍 गट नं २१/पी, वडगाव-तिसगाव मेन रोड, वडगाव (को) ता. जि. छ. संभाजीनगर



विमल
शांती
शिल्डर्स



Project By
PADMAVATI
Builders And Developers

GARDEN 3D VIEW

**विमल
शांती**
शेल्डर्स

Your Dream Home Is Just A Visit Away,
Book Today And Embrace A New Way Of Living!"



आपका ड्रीम होम अब बस एक विज़िट दूर,
अभी बुक करें और बेहतर जीवन की ओर बढ़ें!

OPEN SPACE & PLAY GROUND

"Experience The Perfect Blend Of Comfort & Luxury With Our Exclusive 2 Bhk Rowhouses. Designed To Elevate Your Lifestyle, Each Home Features Spacious Interiors, Modern Amenities, And A Private Parking Space.

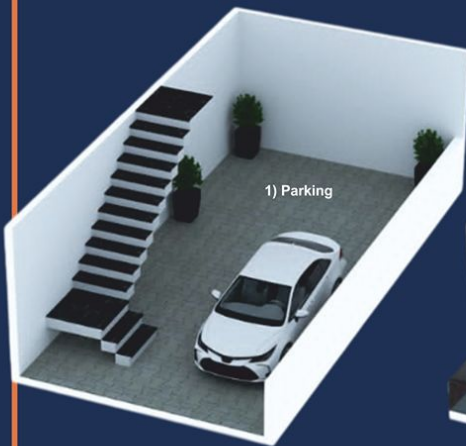

PARKING / GROUND FLOOR



FIRST FLOOR PLAN



SECOND FLOOR PLAN

- 1) Drawing Hall
- 2) Kitchen & Dinning
- 3) Toilet
- 4) Balcony

- 1) Bed Room
- 2) Toilet
- 3) Bed Room
- 4) Balcony

विमल
शांती
शेल्टर्स

Project By
PADMAVATI
Builders And Developers

3D BIRD EYE VIEW

FLOOR PLANS



PARKING / GROUND FLOOR

FIRST FLOOR PLAN

SECOND FLOOR PLAN



विमल
शांती
शेल्डर्स



ROW HOUSE FRONT ELEVATION 3D VIEW

SPECIFICATION

STRUCTURE

A class RCC framed Earthquake resistant structure. 6" thick brick work external wall & 4" thick brick internal walls.

FLOORING

Vitrified flooring in all rooms 2x27 height tiles in toilet & anti skid files flooring.

KITCHEN

Specious granite kitchen platform with, stainless steel sink. One loft in kitchen & bed.

PLUMBING

Concealed plumbing with C.P. hot-cold mixer unit & exclusive fittings. Solar water pipe fitting

ELECTRIFICATION

Concealed wiring in all rooms. 3.5 in each room, power point in kitchen & bathroom, T.V. & Telephone points in living room: Also Charging point for E-Vehicles & other uses in parking. Invertor fitting provision in living & bed rooms.

WATER TANK: TERRACE TANK 500 ITRS. & UNDERGROUND TANK 2000 ITRS.

PLASTER

Sand faced plaster externally & neeru finish plaster internally.

DOOR

Main Door in teak wood frame & Other Door RCC frames with flush doors. Toilet Door RCC frames with Fiber Panel

WINDOW

Powder coated three track aluminum sliding windows with mosquito net & M.S. fabricated grill.

PAINTING

O.B.D. painting inside walls & ceiling of all rooms. ESE/Apex paint from outside. Oil paint to all doors & grills

PARKING

Concrete covered parking. Open Space for Garden.

AMENITIES FOR ROW HOUSE



GARDEN



ENTRANCE GATE



INTERNAL CONCRETE WAY



SECURITY CABIN



55000 LTRS SAFETY TANK



STREET LIGHT



2000 LTRS WATER TANK



SEPARATE WATER LINE



SEPARATE DRAINAGE LINE

LOCATION PLAN



Site Address:

Vimal Shanti Shelter, Gut No.21, Wadgaon Kolhati
Bajaj Nagar, Chhatrapati Sambhajinagar.



MAHARERA
No.P51500023715



सर्व राष्ट्रीयकृत बँकांकडून
गृहकर्ज घेण्यास योग्य प्रोजेक्ट

Project By
PADMAVATI
Builders And Developers

CONTACT FOR BOOKING
8888863828 | 8793271201

PROPERTY / LAND OWNER
Anil Shantilalji Chordiya

ARCHITECT & RCC DESIGNER
Tanpure Patil & Associates

📍 गट नं २१/पी, वडगाव-तिसगाव मेन रोड, वडगाव (को) ता. जि. छ. संभाजीनगर

Note: The contents of this brochure are purely conceptual and do not have any legal binding on us. The developers reserve the right to modify the layout, plans, number of floors, flats, elevation, color schemes, specifications, and amenities as deemed necessary.